

ULTEGRA Cassette Sprocket CS-6700 10-Speed

CS-6700 sprocket teeth combinations

| | |
|-----------|---|
| 11 - 23 T | 11 - 12 - 13 - 14 - 15 - 16 - 17 - 19 - 21 - 23 T |
| 11 - 25 T | 11 - 12 - 13 - 14 - 15 - 17 - 19 - 21 - 23 - 25 T |
| 11 - 28 T | 11 - 12 - 13 - 14 - 15 - 17 - 19 - 21 - 24 - 28 T |
| 12 - 23 T | 12 - 13 - 14 - 15 - 16 - 17 - 18 - 19 - 21 - 23 T |
| 12 - 25 T | 12 - 13 - 14 - 15 - 16 - 17 - 19 - 21 - 23 - 25 T |

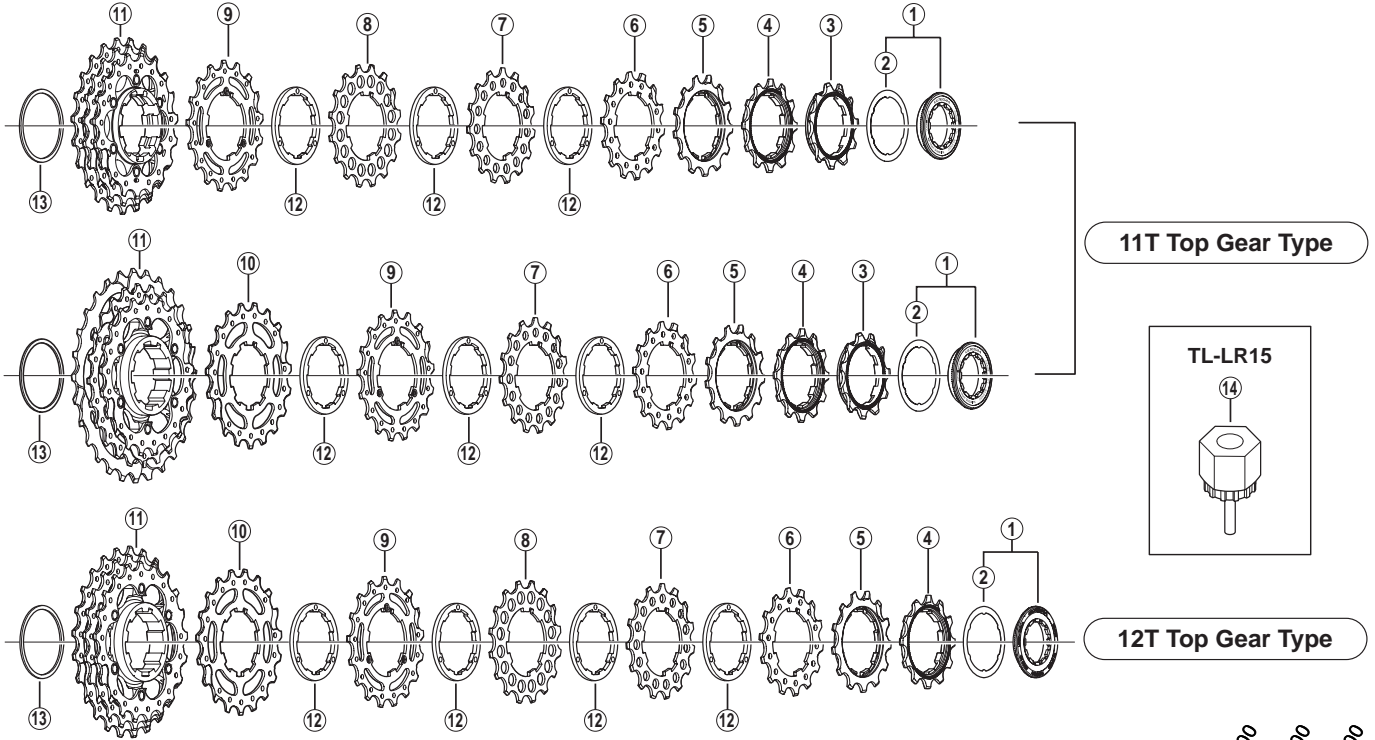

| ITEM NO. | SHIMANO CODE NO. | DESCRIPTION | INTERCHANGEABILITY | | |
|----------|------------------|---|--------------------|---------|---------|
| | | | CS-7900 | CS-6600 | CS-5600 |
| 1 | Y1YX98010 | Lock Ring & Spacer for 11T | B | B | B |
| | Y1YX98020 | Lock Ring & Spacer for 12T | B | B | B |
| 2 | Y10Z04000 | Lock Ring Spacer for 11T | A | A | A |
| | Y11W02000 | Lock Ring Spacer for 12T | A | A | A |
| 3 | Y1Z81100D | Sprocket Wheel 11T (Built in spacer type) | A | A | B |
| 4 | Y1Z81200D | Sprocket Wheel 12T (Built in spacer type) | A | A | B |
| 5 | Y1Z81300D | Sprocket Wheel 13T (Built in spacer type) | A | A | B |
| 6 | Y1Z81400D | Sprocket Wheel 14T | B | A | B |
| 7 | Y1Z81500D | Sprocket Wheel 15T | B | A | B |
| 8 | Y1Z81600D | Sprocket Wheel 16T | B | A | B |
| * 9 | Y1ZD1700E | Sprocket Wheel 17T for 11-23T, 12-23T, 12-25T | | | |
| | Y1YX1700D | Sprocket Wheel 17T for 11-25T, 11-28T | | | |
| 10 | Y1ZD1800E | Sprocket Wheel 18T for 12-23T | | A | |
| | Y1YX1900D | Sprocket Wheel 19T for 11-25T, 11-28T | | | B |
| | Y1ZD1900E | Sprocket Wheel 19T for 12-25T | | A | B |
| 11 | Y1YX98030 | Sprocket Unit (19-21-23T) for 11-23T | | B | B |
| | Y1YX98040 | Sprocket Unit (19-21-23T) for 12-23T | | B | B |
| | Y1YX98050 | Sprocket Unit (21-23-25T) for 11-25T, 12-25T | | B | |
| | Y1YX98060 | Sprocket Unit (21-24-28T) for 11-28T | | B | |
| 12 | Y1Z805000 | Sprocket Spacer (t=2.35 mm) | B | A | B |
| 13 | Y1Z807000 | Low Spacer (t=1.0 mm) | A | A | A |
| 14 | Y12009230 | Lock Ring Removal Tool (TL-LR15) | A | A | A |

A: Same parts.

B: Parts are usable, but differ in materials, appearance, finish, size, etc.

Absence of mark indicates non-interchangeability.

Dec. 2010-2924A

© Shimano Inc. I

Specifications are subject to change without notice.

SHIMANO